

**BRIEF OVERVIEW:**

- APPROX. 285m NORTHBOUND BUS LANE ON A370 PROPOSED. 125m SOUTH-EASTBOUND BUS LANE PROPOSED TO ACCOMMODATE PLANNED 24HR BUS SERVICES BY NSC.

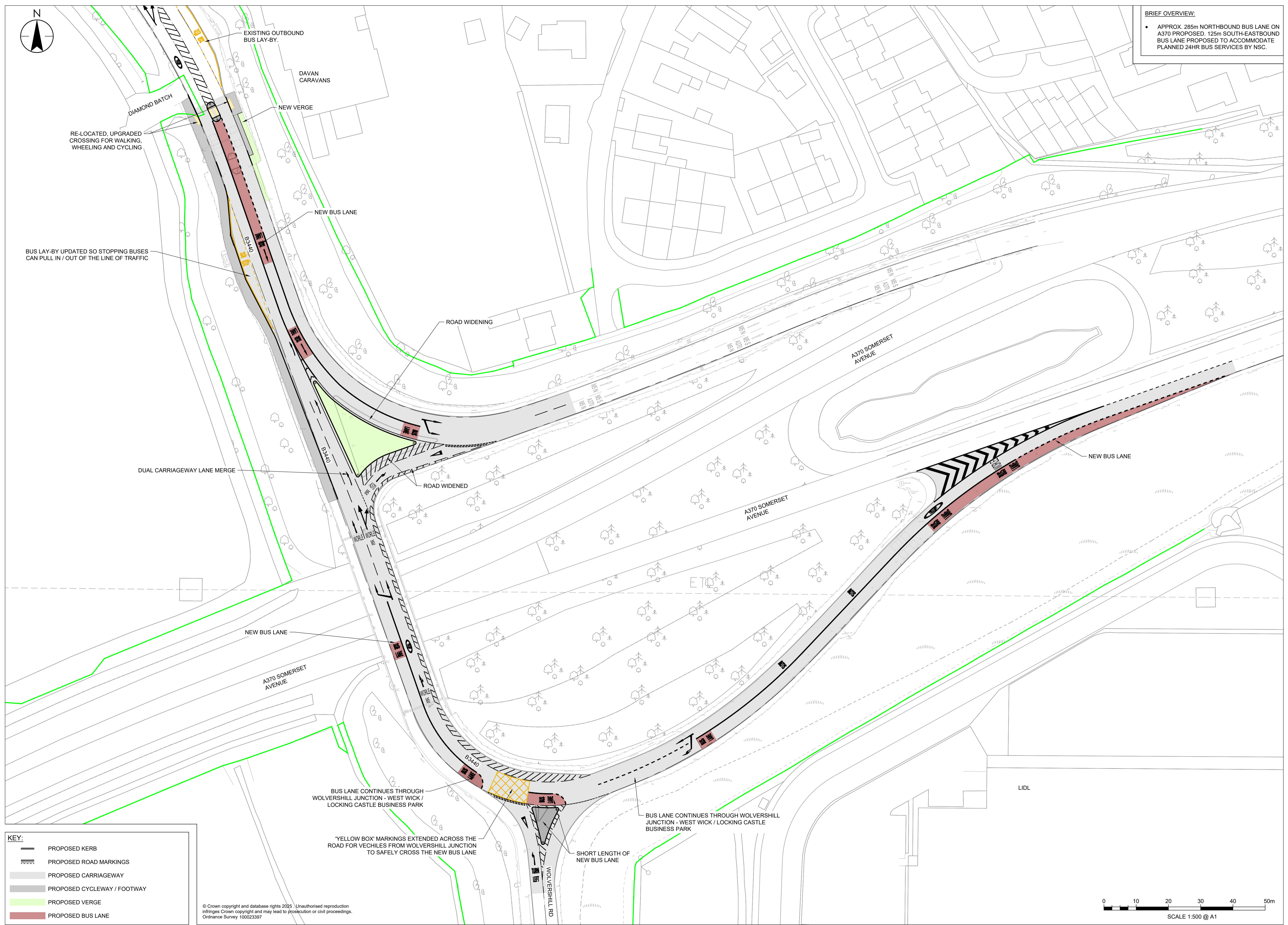

**KEY:**

	PROPOSED KERB
	PROPOSED ROAD MARKINGS
	PROPOSED CARRIAGEWAY
	PROPOSED CYCLEWAY / FOOTWAY
	PROPOSED VERGE
	PROPOSED BUS LANE

© Crown copyright and database rights 2025. Unauthorised reproduction infringes Crown copyright and may lead to prosecution or civil proceedings. Ordnance Survey 100023397

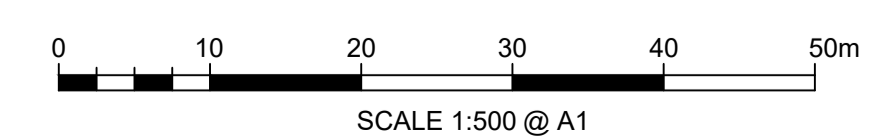

BUS LANE CONTINUES THROUGH WOLVERSHILL JUNCTION - WEST WICK / LOCKING CASTLE BUSINESS PARK

'YELLOW BOX' MARKINGS EXTENDED ACROSS THE ROAD FOR VEHICLES FROM WOLVERSHILL JUNCTION TO SAFELY CROSS THE NEW BUS LANE

SHORT LENGTH OF NEW BUS LANE

BUS LANE CONTINUES THROUGH WOLVERSHILL JUNCTION - WEST WICK / LOCKING CASTLE BUSINESS PARK

RE-LOCATED, UPGRADED CROSSING FOR WALKING, WHEELING AND CYCLING

DIAMOND BATCH

EXISTING OUTBOUND BUS LAY-BY

DAVAN CARAVANS

NEW VERGE

NEW BUS LANE

ROAD WIDENING

A370 SOMERSET AVENUE

DUAL CARRIAGEWAY LANE MERGE

ROAD WIDENED

A370 SOMERSET AVENUE

NEW BUS LANE

A370 SOMERSET AVENUE

LIDL

WOLVERSHILL RD