

0m 5m 10m 20m

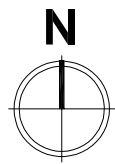

Notes:

1. Do not scale from this drawing
2. This drawing is copyright and may not be copied or given to a third party without written authority from Ashley Helme Associates Ltd
3. Subject to detailed design
4. Based upon topographical survey

Key:

- 2.4m x 23m visibility splay
- 2.4m x 26m visibility splay
- Proposed kerbline

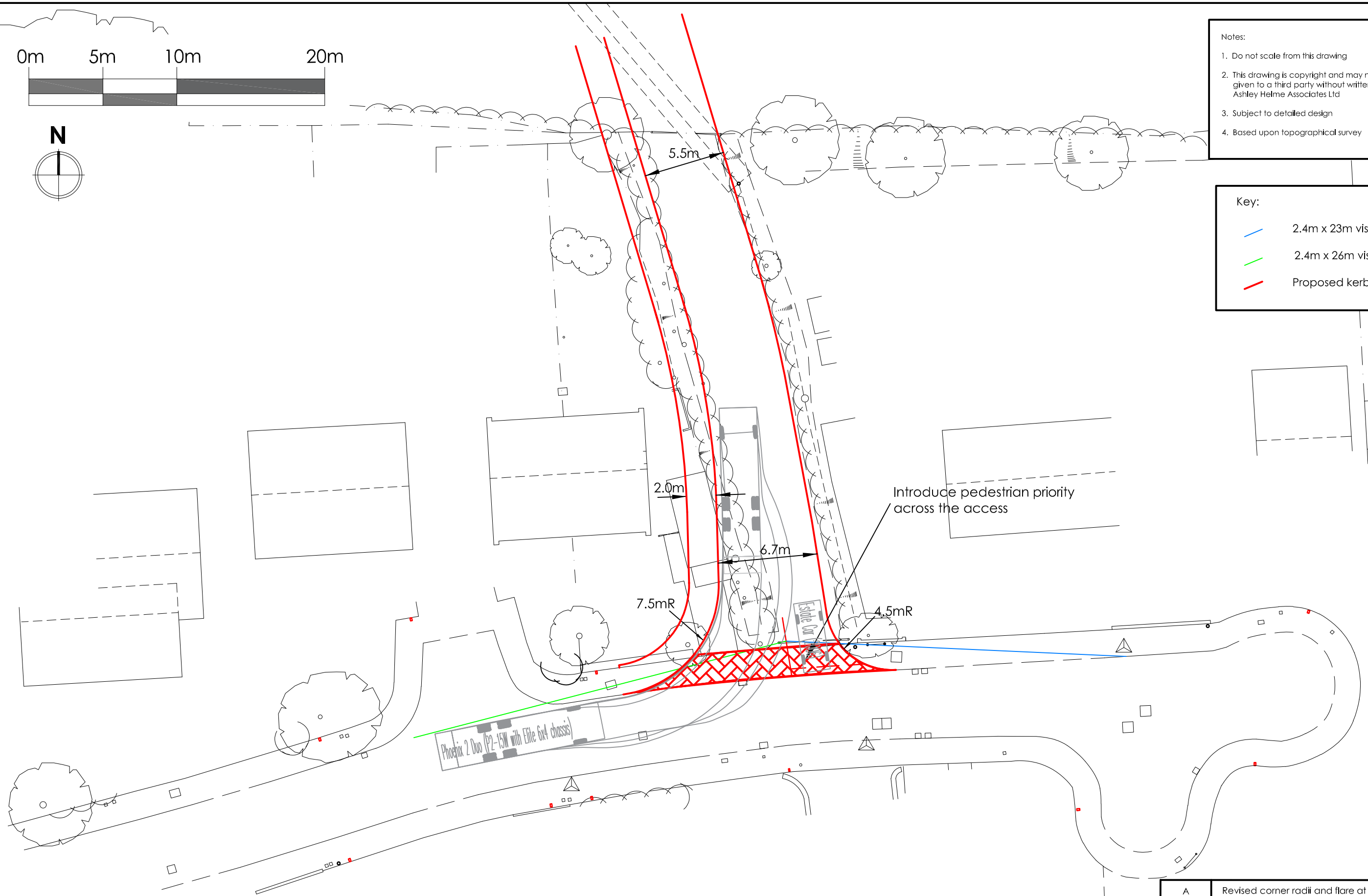

Based upon/reproduced from the Ordnance Survey Map with the Permission of The Controller of Her Majesty's Stationary Office.
© Crown Copyright Ashley Helme Associates Ltd, 76 Washway Road, Sale, Manchester, M33 7RE. Licence No AL100015126

A	Revised corner radii and flare at site access	03.10.22
Rev	Description	Date

Project	MULBERRY ROAD, CONGRESBURY
Client	M7 PLANNING LTD

Title	PROPOSED ACCESS ARRANGEMENTS: OPTION 1
-------	--

Drawing No	1814/01
Date	OCTOBER 2022

Rev	A
Scale	1:250@A3



Telephone 0161 972 0552
 Email aha@ashleyhelme.co.uk
 Website www.ashleyhelme.co.uk
 Address 76 Washway Road, Sale, Manchester, M33 7RE