

**Wildlife and Countryside Act 1981  
Section 53**

**North Somerset District Council**

**(Upgrade Footpath LA20/63 to Bridleway LA20/63  
Oxhouse Lane Failand)  
Definitive Map and Statement Modification  
Order No 1 2016**

**Director of Development and Environment  
Streets and Open Spaces  
Town Hall  
Walliscote Grove Road  
Weston-super-Mare  
BS23 1UJ**

**File ref: Mod 15**

**WILDLIFE AND COUNTRYSIDE ACT 1981**

**THE COUNTY OF SOMERSET DEFINITIVE MAP AND STATEMENT  
LONG ASHTON RURAL DISTRICT**

**NORTH SOMERSET DISTRICT COUNCIL  
(UPGRADE FOOTPATH LA20/63 TO BRIDLEWAY LA20/63  
OXHOUSE LANE FAILAND)**

**DEFINITIVE MAP AND STATEMENT MODIFICATION ORDER NO. 1 2016**

This Order is made by North Somerset District Council ("the Council") under section 53(2) of the Wildlife and Countryside Act 1981 ("the Act") because it appears to that authority that the County of Somerset Definitive Map and Statement Long Ashton Rural District requires modification in consequence of the occurrence of an event specified in section 53(3)(c)(ii) namely the discovery by the authority of evidence which (when considered with all other relevant evidence available to them) shows that a highway shown in the map and statement as a highway of a particular description ought to be there shown as a highway of a different description.

The Council have consulted with every local authority whose area includes the land to which the Order relates. The Council hereby orders that:

1. For the purpose of this Order the relevant date is 1 October 2016.
2. The County of Somerset Definitive Map and Statement Long Ashton Rural District shall be modified as described in Part 1 and Part II of the Schedule and shown on the map attached to the Order.
3. Where immediately before the date on which this Order is confirmed there is apparatus under, in, on, over, along or across it belonging to statutory undertakers for the purpose of carrying on their undertaking, the undertakers shall continue to have the same rights in respect of the apparatus as they then had.
4. This Order shall take effect on the date it is confirmed and may be cited as the North Somerset District Council (Bridleway LA20/63 Oxhouse Lane Failand) Definitive Map and Statement Modification Order No. 1 2016.

## SCHEDULE

### PART I

#### Modification of Definitive Map

#### **Description of path or way to be upgraded**

The footpath commences from point A (Grid Ref: ST51747 72721) on the adopted highway known as Oxhouse Lane and proceeds in a south easterly direction for a distance of approximately 281 metres to point B (Grid Ref: ST51994 72607) where it meets Bridleway LA20/63 as shown on the attached map EB/Mod 15/1. This footpath will be upgraded to bridleway. The available width of the bridleway between point A and point B is 2 metres.

**PART II**

**Modification of Definitive Map and Statement**

Map No.	Class & Right of Way	Description of Route				Particulars as to position, width, limitations or conditions as in the opinion of the Authority it is expedient to record		Reason for inclusion	
		From		General Direction	To				
		County Road or Right of Way	Location (with bounding property Nos.)		County Road or Right of Way				Location (with bounding property Nos.)
EB/Mod 15/1	Bridleway LA20/63	Oxhouse Lane USRN 47817341	Grid Ref: ST 51747 72721	South Easterly	Bridleway LA20/63	Grid Ref: ST 51994 72607	<p>The bridleway commences from point A on the adopted highway known as Oxhouse Lane and proceeds in a south easterly direction for a distance of approximately 281 metres to point B where it meets Bridleway LA20/63 as shown on the attached map. The available width of the bridleway between point A and point B is 2 metres.</p> <p>Wildlife and Countryside Act 1981</p> <p>Modification of Definitive Map to upgrade Footpath LA20/63 to Bridleway LA20/63.</p>		

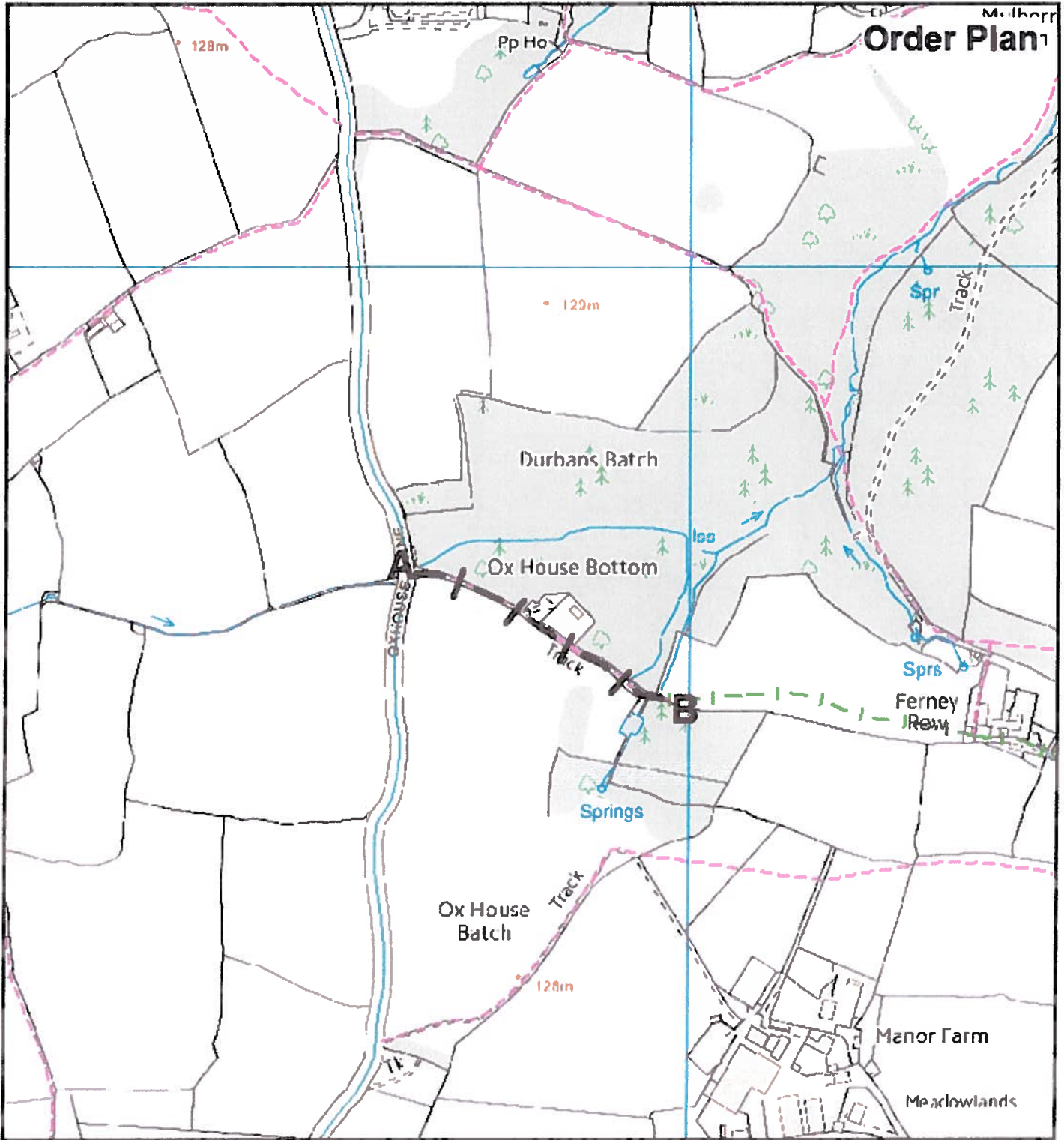

Wildlife & Countryside Act 1981 - Section 54 North Somerset District Council  
**Definitive Map Modification Order No. 1 2016**  
**Upgrade of Footpath LA20/63 to Bridleway LA20/63 Oxhouse Lane Failand**



Development & Environment

Public Rights of Way  
 Streets and Open Spaces  
 North Somerset Council  
 Town Hall  
 Walliscote Grove Road  
 Weston-super-Mare  
 BS23 1UJ  
 Tel: 01934 858 802

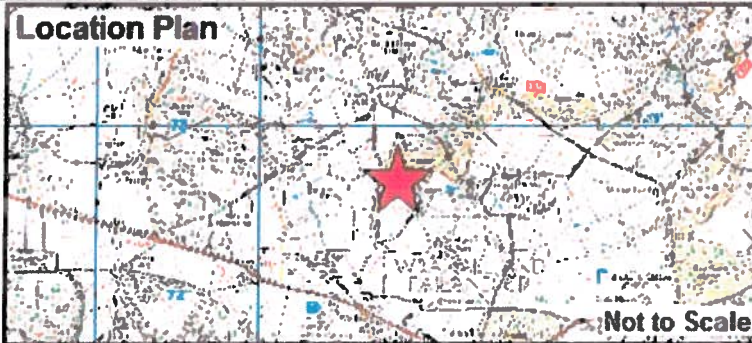

Scale 1:5000

Date 18 August 2016

Grid Ref. ST5172

Map No. EB/Mod 15/1

Claimed Bridleway



Given under the Common Seal of North Somerset District Council on the  
5th day of October 2016.

The COMMON SEAL of )  
NORTH SOMERSET )  
DISTRICT COUNCIL )  
was hereunto affixed in )  
the presence of :- )

A handwritten signature in black ink, appearing to be 'N. P. ...', written over the closing parenthesis of the text above.

16915

HEAD OF LEGAL AND DEMOCRATIC SERVICES

**NORTH SOMERSET DISTRICT COUNCIL** )  
hereby confirms the foregoing )  
Order as an unopposed Order )  
this 17<sup>th</sup> day of February 2017 )



17139

FOR HEAD OF LEGAL AND DEMOCRATIC SERVICES

**Section 53 of the Wildlife and Countryside Act 1981**  
**The County of Somerset Definitive Map and Statement**  
**Long Ashton Rural District**

**North Somerset District Council**  
**(Upgrade Footpath LA20/63 to Bridleway LA20/63 Oxhouse Lane Failand)**  
**Definitive Map and Statement Modification Order No 1 2016**

The above named Order made on 5<sup>th</sup> October 2016, under Section 53 Wildlife and Countryside Act 1981 was confirmed by North Somerset Council on 17<sup>th</sup> February 2017.

The effect of this Order is to modify the definitive map and statement for the area by recording accurately the use which is being made of this route which is a continuation of bridleways passing through Failand Farm.

The bridleway commences from point A (Grid Ref: ST51747 72721) on the adopted highway known as Oxhouse Lane and proceeds in a south westerly direction for a distance of approximately 281 metres to point B (Grid Ref: ST51994 72607) where it meets the continuation of Bridleway LA20/63 as shown on the attached map EB/Mod 15/1. The available width of the bridleway between point A and point B is 2 metres.

A copy of the confirmed Order and the Order map may be seen free of charge at the reception of North Somerset Council Offices, Castlewood, Tickenham Road, Clevedon (Opposite Clevedon Garages) from 9am to 4.30pm, Monday to Thursday (4.00pm Friday) or may be viewed on the Council's website [www.n-somerset.gov.uk/notices](http://www.n-somerset.gov.uk/notices). A copy is also available for inspection at Failand Post Office Stores, 89 Clevedon Road, Bristol, BS8 3UL during normal opening hours of 6.30am to 6.30pm. Photocopies can be supplied subject to applicable charges.

The Order came into force on 17<sup>th</sup> February 2017, but if a person aggrieved by the Order wants to question its validity, or that of any provision contained in it, on the ground that it is not within the powers of Section 53 of the Wildlife and Countryside Act 1981, as amended, or on the ground that any requirement of the Act, or on the ground that any requirement of Schedule 15 to the Act, or of any regulation made under the Act has not been complied with in relation to the Order, he or she may, under paragraph 12 of Schedule 15 to the Act, within six weeks from 23<sup>rd</sup> February 2017, make an application to the High Court.

Dated 23<sup>rd</sup> February 2017

**D Carter**  
**Director of Development & Environment**