



DECISION OF DIRECTOR OF DEVELOPMENT AND ENVIRONMENT

DECISION NO. 16/17 DE 31

SUBJECT:

Allocation of a postal address to a new flat following application: 15/P/0538/F. Subdivision of first and second floor flat to create 2no. self contained flats. Erection of dormer to rear elevation. Location: 29 Clarence Road North, Weston-super-Mare, BS23 4AW.

Background:

Request received from the Developer to allocate a postal address to the new flat.

DECISION:

Sections 64 and 65 Towns Improvement Clauses Act 1847 incorporated into S160 of the Public Health Act 1875 for urban areas and wellbeing power under the Local Government Act 2000 for rural areas. The Developer, Royal Mail and the Corporate Services Directorate have been consulted and have agreed to the address as shown below

**29C CLARENCE ROAD NORTH
WESTON-SUPER-MARE
BS23 4AW**

Reasons:

To provide an adequate means of identifying the new flat. Please note that this numbering does not conform to our street naming and numbering policy, however the current numbering of 29 (ground floor flat), 29A (original first and second floor flat) and 29B (coach house to the rear of main building) has been in use for a number of years and any new numbering needs to therefore continue with the existing format.

Other Alternatives Considered:

None

Risk Assessment:

None

Financial Implications:

None

Implications for Future Years:

None

Signed J. Marcom.....

On behalf of the Director of Development and Environment and in accordance with Decision No 15/16-16/17 DE 300

Dated 8/6/16.....

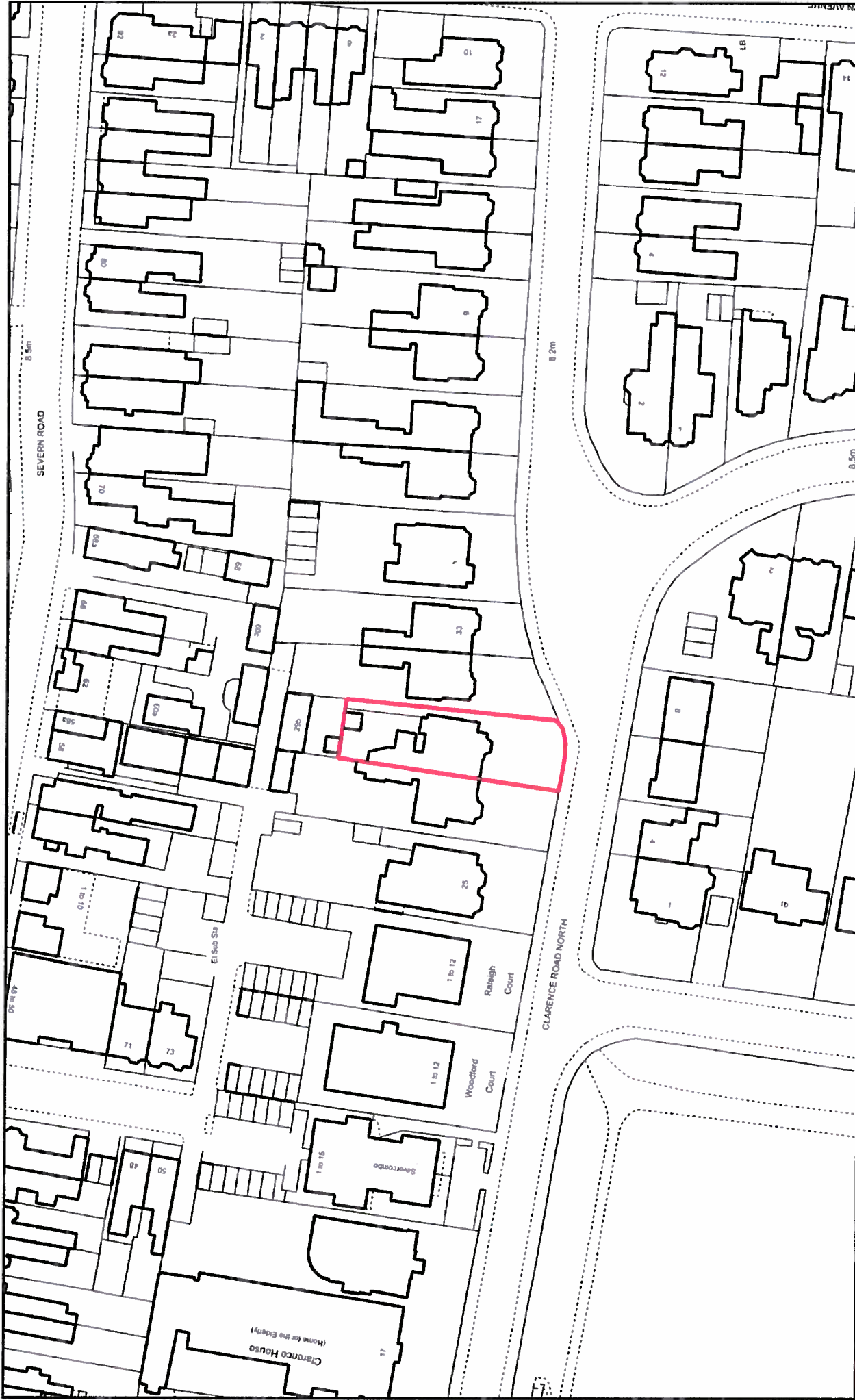

SNN3456 29C Clarence Road North, Weston-super-Mare

Scale: 1:1000

Date: 08 June 2016

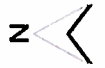

© Crown copyright and database rights 2018 Ordnance Survey 1000272387. You are not permitted to copy, sub-license, distribute or sell any of this data to third parties in any form. © Aerial Photography 2000 Imagery copyright Getmapping P.L.C. www.getmapping.com. © and database right Crown Copyright and Landmark Information Group Ltd. (All rights reserved (2016)).

