



DECISION OF DIRECTOR OF DEVELOPMENT AND ENVIRONMENT

DECISION NO. 16/17 DE 79

SUBJECT:

Allocation of postal addresses. Demolition of pair of semi-detached bungalows and erection of 36no. one, two, three and four bedroom dwellings with associated parking, landscaping, pumping station and vehicular access from Wellsea Grove Planning application: 14/P/0156/F
Location: Land to rear of Wellsea Grove, Weston-super-Mare.

Background:

Request from the developer to allocate postal addresses to the new residential dwellings.

DECISION:

Sections 64 and 65 Towns Improvement Clauses Act 1847 incorporated into s160 of the Public Health Act 1875 for urban areas and wellbeing power under the Local Government Act 2000 for rural areas. To allocate a postal address to the new dwellings. The Developer, Royal Mail, Town Council and the Corporate Services Directorate have been consulted and have agreed to the decision as outlined below:

1 – 35 (cons), Hay Grove, Weston-super-Mare. *Postcode to be assigned by Royal Mail.*
17 Wellsea Grove, Weston-super-Mare, BS23 3LZ.

Please note that the allocated street numbers match up with the plot numbers on the associated plan except for plot 36 which will be 17 Wellsea Grove.

Reasons:

To provide an adequate means of identifying the residential properties.

Other Alternatives Considered:

None

Risk Assessment:

None

Financial Implications:

None

Implications for Future Years:

None

Signed.....

On behalf of the Director of Development and Environment and in accordance with Decision No 15/16-16/17 DE 300

Dated.....12/10/16.....

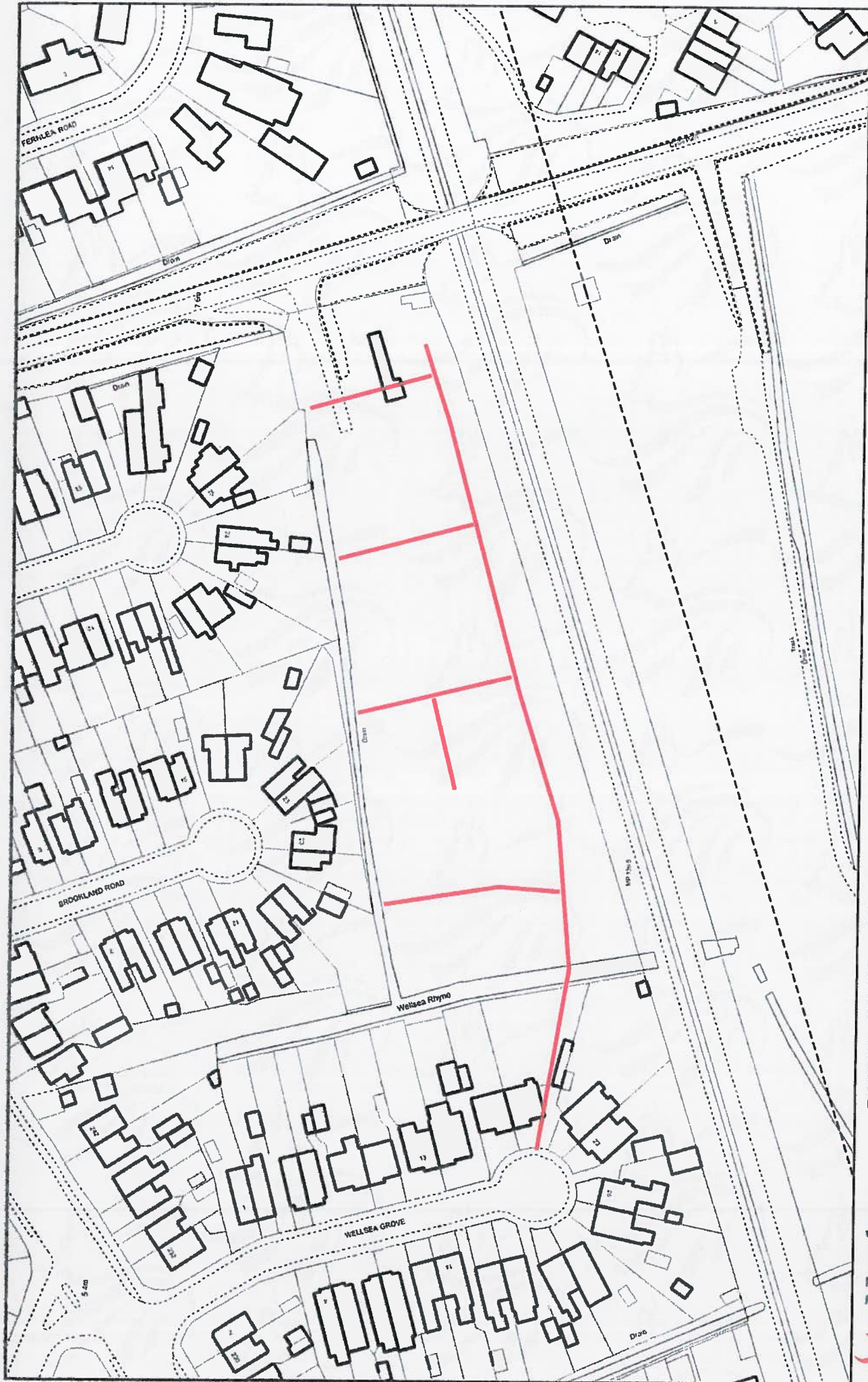

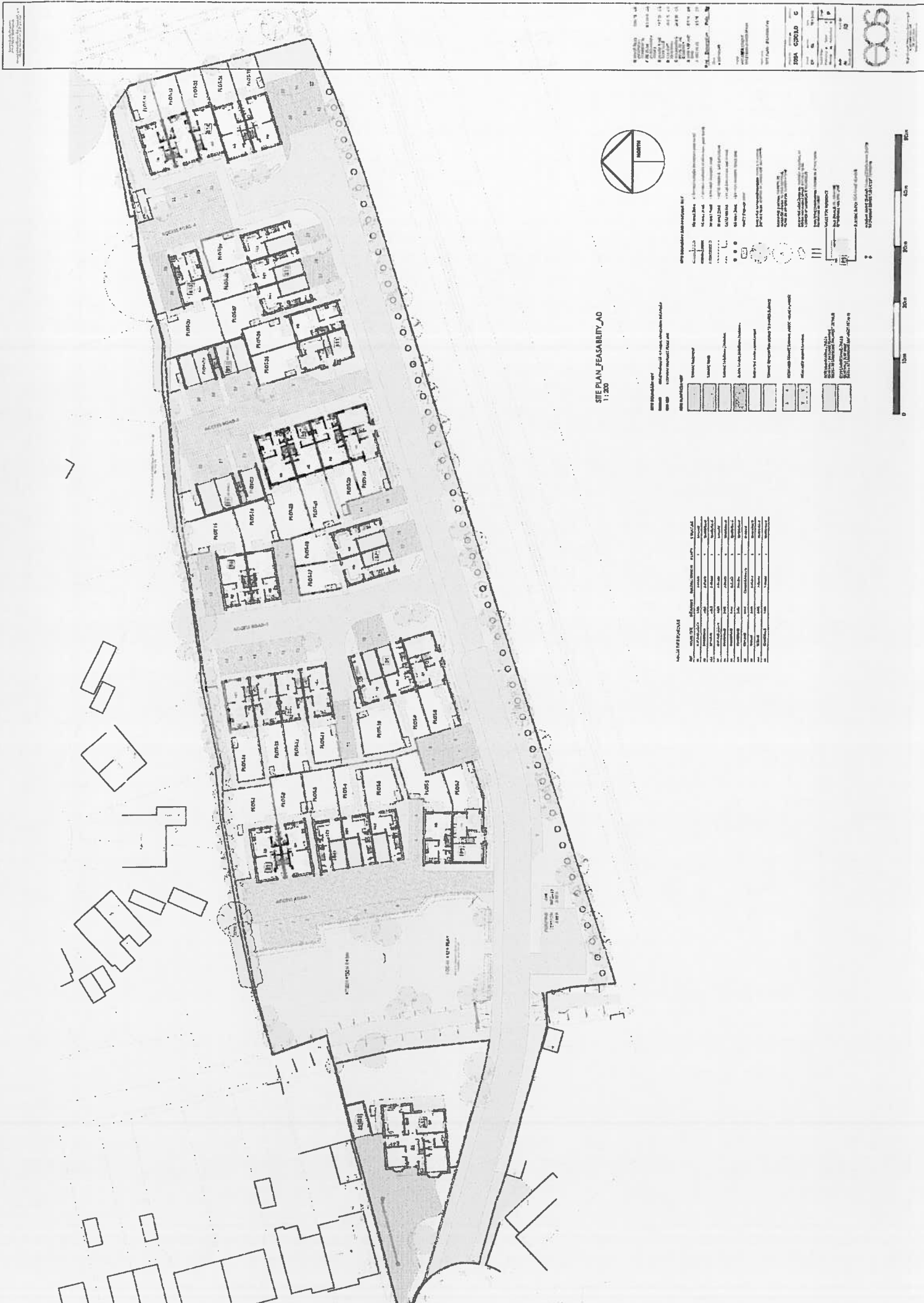

SITE PLAN FEASIBILITY_A0
1:200



PROJ: [unreadable]
DATE: [unreadable]
SCALE: 1:200

- LEGEND**
- Site Boundary
 - Access Road
 - Proposed Building Footprint
 - Proposed Parking Space
 - Proposed Landscaping
 - Proposed Fencing
 - Proposed Gate
 - Proposed Gate Post
 - Proposed Gate Pillar
 - Proposed Gate Light
 - Proposed Gate Sign
 - Proposed Gate Lock
 - Proposed Gate Alarm
 - Proposed Gate Camera
 - Proposed Gate Intercom
 - Proposed Gate Access Control
 - Proposed Gate Barrier
 - Proposed Gate Boom
 - Proposed Gate Turnstile
 - Proposed Gate Escalator
 - Proposed Gate Staircase
 - Proposed Gate Lift
 - Proposed Gate Ramp
 - Proposed Gate Platform
 - Proposed Gate Shelter
 - Proposed Gate Canopy
 - Proposed Gate Awning
 - Proposed Gate Umbrella
 - Proposed Gate Sunshade
 - Proposed Gate Rainwater Harvesting
 - Proposed Gate Solar Panel
 - Proposed Gate Wind Turbine
 - Proposed Gate Water Tower
 - Proposed Gate Power Plant
 - Proposed Gate Cooling Tower
 - Proposed Gate Air Conditioning
 - Proposed Gate Heating System
 - Proposed Gate Ventilation System
 - Proposed Gate Filtration System
 - Proposed Gate Purification System
 - Proposed Gate Disinfection System
 - Proposed Gate Sterilization System
 - Proposed Gate Incubation System
 - Proposed Gate Fermentation System
 - Proposed Gate Distillation System
 - Proposed Gate Evaporation System
 - Proposed Gate Condensation System
 - Proposed Gate Crystallization System
 - Proposed Gate Precipitation System
 - Proposed Gate Filtration System
 - Proposed Gate Adsorption System
 - Proposed Gate Ion Exchange System
 - Proposed Gate Reverse Osmosis System
 - Proposed Gate Ultrafiltration System
 - Proposed Gate Microfiltration System
 - Proposed Gate Nanofiltration System
 - Proposed Gate Membrane Bioreactor System
 - Proposed Gate Activated Sludge System
 - Proposed Gate Trickling Filter System
 - Proposed Gate Rotating Biological Contactors System
 - Proposed Gate Oxidation Pond System
 - Proposed Gate Aerobic Granular Sludge System
 - Proposed Gate Anaerobic Digestion System
 - Proposed Gate Sulfuric Acid Production System
 - Proposed Gate Nitric Acid Production System
 - Proposed Gate Phosphoric Acid Production System
 - Proposed Gate Sulfuric Acid Recovery System
 - Proposed Gate Nitric Acid Recovery System
 - Proposed Gate Phosphoric Acid Recovery System
 - Proposed Gate Sulfuric Acid Storage System
 - Proposed Gate Nitric Acid Storage System
 - Proposed Gate Phosphoric Acid Storage System
 - Proposed Gate Sulfuric Acid Distribution System
 - Proposed Gate Nitric Acid Distribution System
 - Proposed Gate Phosphoric Acid Distribution System
 - Proposed Gate Sulfuric Acid Sales System
 - Proposed Gate Nitric Acid Sales System
 - Proposed Gate Phosphoric Acid Sales System

ROOM SCHEDULE

ROOM NO.	ROOM NAME	AREA (SQM)	STATUS
R101	Office	100	Proposed
R102	Office	100	Proposed
R103	Office	100	Proposed
R104	Office	100	Proposed
R105	Office	100	Proposed
R106	Office	100	Proposed
R107	Office	100	Proposed
R108	Office	100	Proposed
R109	Office	100	Proposed
R110	Office	100	Proposed
R111	Office	100	Proposed
R112	Office	100	Proposed
R113	Office	100	Proposed
R114	Office	100	Proposed
R115	Office	100	Proposed
R116	Office	100	Proposed
R117	Office	100	Proposed
R118	Office	100	Proposed
R119	Office	100	Proposed
R120	Office	100	Proposed
R121	Office	100	Proposed
R122	Office	100	Proposed
R123	Office	100	Proposed
R124	Office	100	Proposed
R125	Office	100	Proposed
R126	Office	100	Proposed
R127	Office	100	Proposed
R128	Office	100	Proposed
R129	Office	100	Proposed
R130	Office	100	Proposed
R131	Office	100	Proposed
R132	Office	100	Proposed
R133	Office	100	Proposed
R134	Office	100	Proposed
R135	Office	100	Proposed
R136	Office	100	Proposed
R137	Office	100	Proposed
R138	Office	100	Proposed
R139	Office	100	Proposed
R140	Office	100	Proposed
R141	Office	100	Proposed
R142	Office	100	Proposed
R143	Office	100	Proposed
R144	Office	100	Proposed
R145	Office	100	Proposed
R146	Office	100	Proposed
R147	Office	100	Proposed
R148	Office	100	Proposed
R149	Office	100	Proposed
R150	Office	100	Proposed
R151	Office	100	Proposed
R152	Office	100	Proposed
R153	Office	100	Proposed
R154	Office	100	Proposed
R155	Office	100	Proposed
R156	Office	100	Proposed
R157	Office	100	Proposed
R158	Office	100	Proposed
R159	Office	100	Proposed
R160	Office	100	Proposed
R161	Office	100	Proposed
R162	Office	100	Proposed
R163	Office	100	Proposed
R164	Office	100	Proposed
R165	Office	100	Proposed
R166	Office	100	Proposed
R167	Office	100	Proposed
R168	Office	100	Proposed
R169	Office	100	Proposed
R170	Office	100	Proposed
R171	Office	100	Proposed
R172	Office	100	Proposed
R173	Office	100	Proposed
R174	Office	100	Proposed
R175	Office	100	Proposed
R176	Office	100	Proposed
R177	Office	100	Proposed
R178	Office	100	Proposed
R179	Office	100	Proposed
R180	Office	100	Proposed
R181	Office	100	Proposed
R182	Office	100	Proposed
R183	Office	100	Proposed
R184	Office	100	Proposed
R185	Office	100	Proposed
R186	Office	100	Proposed
R187	Office	100	Proposed
R188	Office	100	Proposed
R189	Office	100	Proposed
R190	Office	100	Proposed
R191	Office	100	Proposed
R192	Office	100	Proposed
R193	Office	100	Proposed
R194	Office	100	Proposed
R195	Office	100	Proposed
R196	Office	100	Proposed
R197	Office	100	Proposed
R198	Office	100	Proposed
R199	Office	100	Proposed
R200	Office	100	Proposed
R201	Office	100	Proposed
R202	Office	100	Proposed
R203	Office	100	Proposed
R204	Office	100	Proposed
R205	Office	100	Proposed
R206	Office	100	Proposed
R207	Office	100	Proposed
R208	Office	100	Proposed
R209	Office	100	Proposed
R210	Office	100	Proposed
R211	Office	100	Proposed
R212	Office	100	Proposed
R213	Office	100	Proposed
R214	Office	100	Proposed
R215	Office	100	Proposed
R216	Office	100	Proposed
R217	Office	100	Proposed
R218	Office	100	Proposed
R219	Office	100	Proposed
R220	Office	100	Proposed
R221	Office	100	Proposed
R222	Office	100	Proposed
R223	Office	100	Proposed
R224	Office	100	Proposed
R225	Office	100	Proposed
R226	Office	100	Proposed
R227	Office	100	Proposed
R228	Office	100	Proposed
R229	Office	100	Proposed
R230	Office	100	Proposed
R231	Office	100	Proposed
R232	Office	100	Proposed
R233	Office	100	Proposed
R234	Office	100	Proposed
R235	Office	100	Proposed
R236	Office	100	Proposed
R237	Office	100	Proposed
R238	Office	100	Proposed
R239	Office	100	Proposed
R240	Office	100	Proposed
R241	Office	100	Proposed
R242	Office	100	Proposed
R243	Office	100	Proposed
R244	Office	100	Proposed
R245	Office	100	Proposed
R246	Office	100	Proposed
R247	Office	100	Proposed
R248	Office	100	Proposed
R249	Office	100	Proposed
R250	Office	100	Proposed
R251	Office	100	Proposed
R252	Office	100	Proposed
R253	Office	100	Proposed
R254	Office	100	Proposed
R255	Office	100	Proposed
R256	Office	100	Proposed
R257	Office	100	Proposed
R258	Office	100	Proposed
R259	Office	100	Proposed
R260	Office	100	Proposed
R261	Office	100	Proposed
R262	Office	100	Proposed
R263	Office	100	Proposed
R264	Office	100	Proposed
R265	Office	100	Proposed
R266	Office	100	Proposed
R267	Office	100	Proposed
R268	Office	100	Proposed
R269	Office	100	Proposed
R270	Office	100	Proposed
R271	Office	100	Proposed
R272	Office	100	Proposed
R273	Office	100	Proposed
R274	Office	100	Proposed
R275	Office	100	Proposed
R276	Office	100	Proposed
R277	Office	100	Proposed
R278	Office	100	Proposed
R279	Office	100	Proposed
R280	Office	100	Proposed
R281	Office	100	Proposed
R282	Office	100	Proposed
R283	Office	100	Proposed
R284	Office	100	Proposed
R285	Office	100	Proposed
R286	Office	100	Proposed
R287	Office	100	Proposed
R288	Office	100	Proposed
R289	Office	100	Proposed
R290	Office	100	Proposed
R291	Office	100	Proposed
R292	Office	100	Proposed
R293	Office	100	Proposed
R294	Office	100	Proposed
R295	Office	100	Proposed
R296	Office	100	Proposed
R297	Office	100	Proposed
R298	Office	100	Proposed
R299	Office	100	Proposed
R300	Office	100	Proposed



SNN3507 - development off Wellsea Grove, Weston-super-Mare
UPRN= Unique Property Reference Number

UPRN	No. of bedrooms	Plot No.	House No.	Road Name	Post Town	Postcode
24145231	3	1	1	Hay Grove	Weston-super-Mare	To be Assigned by Royal Mail
24145232	3	2	2	Hay Grove	Weston-super-Mare	To be Assigned by Royal Mail
24145233	3	3	3	Hay Grove	Weston-super-Mare	To be Assigned by Royal Mail
24145234	3	4	4	Hay Grove	Weston-super-Mare	To be Assigned by Royal Mail
24145235	3	5	5	Hay Grove	Weston-super-Mare	To be Assigned by Royal Mail
24145236	3	6	6	Hay Grove	Weston-super-Mare	To be Assigned by Royal Mail
24145237	3	7	7	Hay Grove	Weston-super-Mare	To be Assigned by Royal Mail
24145238	3	8	8	Hay Grove	Weston-super-Mare	To be Assigned by Royal Mail
24145239	3	9	9	Hay Grove	Weston-super-Mare	To be Assigned by Royal Mail
24145240	3	10	10	Hay Grove	Weston-super-Mare	To be Assigned by Royal Mail
24145241	2	11	11	Hay Grove	Weston-super-Mare	To be Assigned by Royal Mail
24145242	2	12	12	Hay Grove	Weston-super-Mare	To be Assigned by Royal Mail
24145243	2	13	13	Hay Grove	Weston-super-Mare	To be Assigned by Royal Mail
24145244	2	14	14	Hay Grove	Weston-super-Mare	To be Assigned by Royal Mail
24145245	3	15	15	Hay Grove	Weston-super-Mare	To be Assigned by Royal Mail
24145246	3	16	16	Hay Grove	Weston-super-Mare	To be Assigned by Royal Mail
24145247	3	17	17	Hay Grove	Weston-super-Mare	To be Assigned by Royal Mail
24145248	3	18	18	Hay Grove	Weston-super-Mare	To be Assigned by Royal Mail
24145249	3	19	19	Hay Grove	Weston-super-Mare	To be Assigned by Royal Mail
24145250	3	20	20	Hay Grove	Weston-super-Mare	To be Assigned by Royal Mail
24145251	3	21	21	Hay Grove	Weston-super-Mare	To be Assigned by Royal Mail
24145252	3	22	22	Hay Grove	Weston-super-Mare	To be Assigned by Royal Mail
24145253	2	23	23	Hay Grove	Weston-super-Mare	To be Assigned by Royal Mail
24145254	1	24	24	Hay Grove	Weston-super-Mare	To be Assigned by Royal Mail
24145255	3	25	25	Hay Grove	Weston-super-Mare	To be Assigned by Royal Mail
24145256	3	26	26	Hay Grove	Weston-super-Mare	To be Assigned by Royal Mail
24145257	3	27	27	Hay Grove	Weston-super-Mare	To be Assigned by Royal Mail

