



## **DECISION OF DIRECTOR OF DEVELOPMENT AND ENVIRONMENT**

**DECISION NO. 16/17 DE 61**

**SUBJECT:**

Allocation of postal addresses. Erection of an apartment block with 9no. Apartments. Associated parking and amenity. Demolition of existing building. Planning application: 15/P/1490/F Location: Police Station Queens Road Clevedon BS21 7TF.

**Background:**

Request from the developer to allocate postal addresses to the new units.

**DECISION:**

Sections 64 and 65 Towns Improvement Clauses Act 1847 incorporated into s160 of the Public Health Act 1875 for urban areas and wellbeing power under the Local Government Act 2000 for rural areas. To allocate postal addresses to the new units. The Developer, Royal Mail and the Corporate Services Directorate have been consulted and have agreed to the decision as shown below.

Flats 1-9  
16 Queens Road  
CLEVEDON  
*Postcode to be allocated by Royal Mail*

With an alias of 'Curzon Court'

**Reasons:**

To provide an adequate means of identifying the properties.

**Other Alternatives Considered:**

None

**Risk Assessment:**

None

**Financial Implications:**

None

**Implications for Future Years:**

None

Signed.....*J. Martin*.....

On behalf of the Director of Development and Environment and in accordance with Decision No 15/16-16/17 DE 300

Dated.....*3/10/16*.....

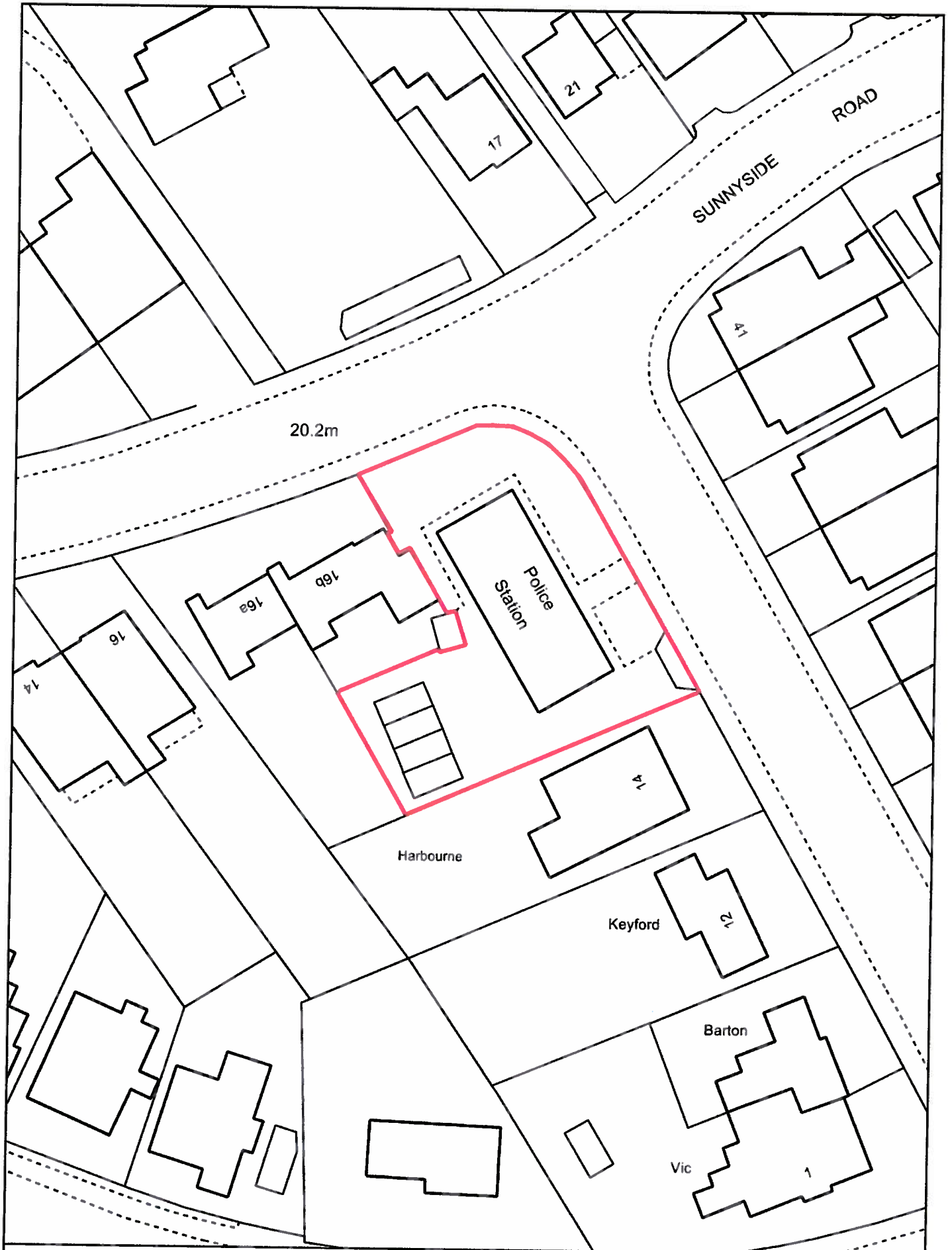



<b>FLAT NUMBER</b>	<b>PROPERTY ALIAS</b>	<b>PROPERTY NUMBER</b>	<b>STREET NAME</b>	<b>POSTTOWN</b>	<b>POSTCODE</b>	<b>FLOOR</b>	<b>UPRN</b>
1	CURZON COURT		16 QUEENS ROAD	CLEVEDON	<i>To be allocated by Royal Mail</i>	Ground Floor	24144955
2	CURZON COURT		16 QUEENS ROAD	CLEVEDON	<i>To be allocated by Royal Mail</i>	Ground Floor	24144956
3	CURZON COURT		16 QUEENS ROAD	CLEVEDON	<i>To be allocated by Royal Mail</i>	Ground Floor	24144957
4	CURZON COURT		16 QUEENS ROAD	CLEVEDON	<i>To be allocated by Royal Mail</i>	First Floor	24144958
5	CURZON COURT		16 QUEENS ROAD	CLEVEDON	<i>To be allocated by Royal Mail</i>	First Floor	24144959
6	CURZON COURT		16 QUEENS ROAD	CLEVEDON	<i>To be allocated by Royal Mail</i>	First Floor	24144960
7	CURZON COURT		16 QUEENS ROAD	CLEVEDON	<i>To be allocated by Royal Mail</i>	Second Floor	24144961
8	CURZON COURT		16 QUEENS ROAD	CLEVEDON	<i>To be allocated by Royal Mail</i>	Second Floor	24144962
9	CURZON COURT		16 QUEENS ROAD	CLEVEDON	<i>To be allocated by Royal Mail</i>	Second Floor	24144963



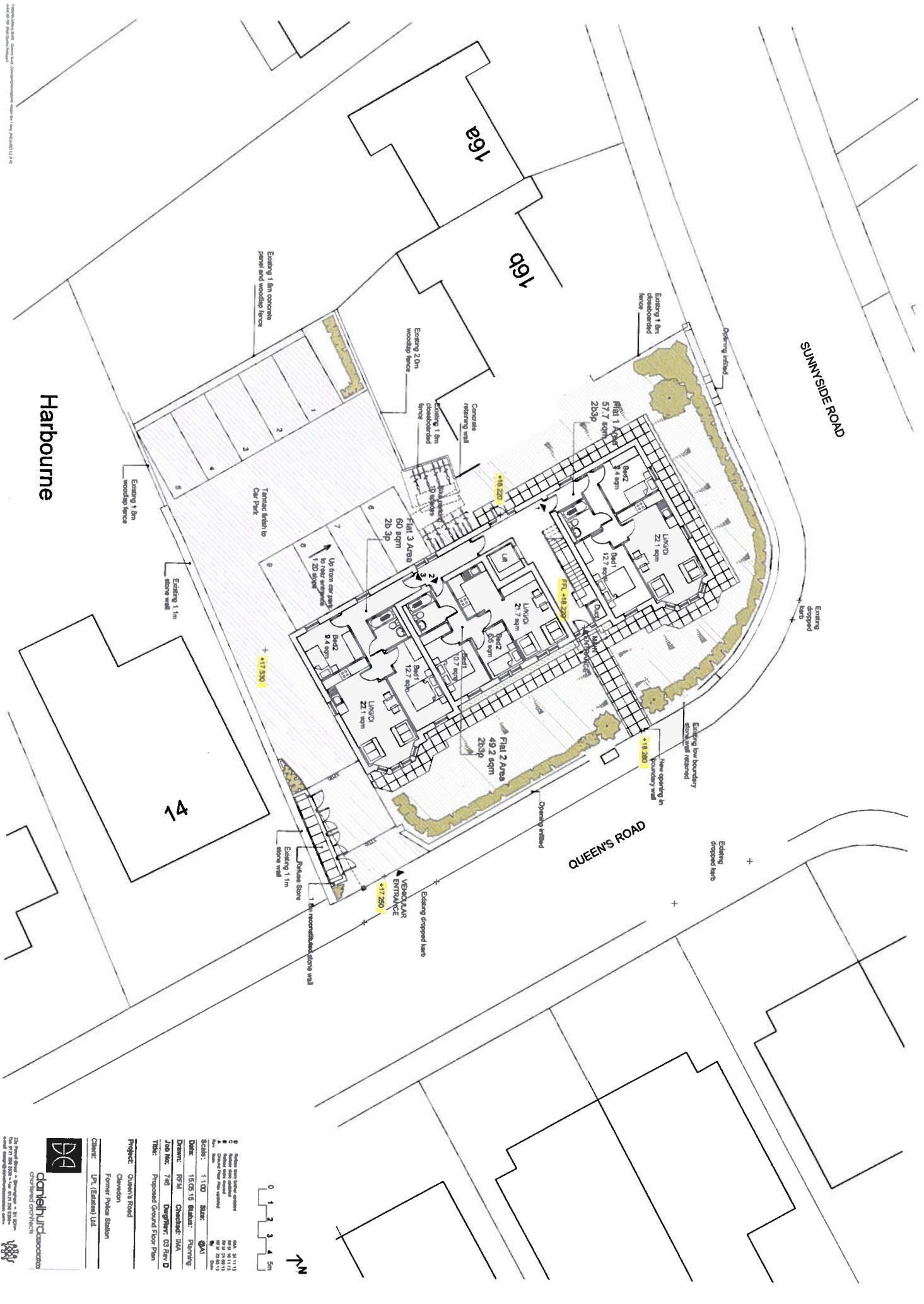

Harbourne

SUNNYSIDE ROAD

QUEEN'S ROAD

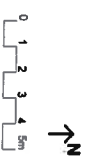

9: Multiple times before advised  
 8: Multiple times before advised  
 7: Multiple times before advised  
 6: Multiple times before advised  
 5: Multiple times before advised  
 4: Multiple times before advised  
 3: Multiple times before advised  
 2: Multiple times before advised  
 1: Multiple times before advised  
 Scale: 1:100 S128P  
 Date: 15.03.15 Status: Planning  
 Drawn: RFL Checked: DAA  
 Job No: 747 Designer: CD Rev D  
 Title: Proposed Ground Floor Plan

Project: Queen's Road  
 Clevedon  
 Former Police Station  
 Client: UPL (Easton) Ltd



25 Portland Road - Brighton - BN1 2PB  
 Tel: 01273 200000  
 Email: info@danishhurst.com  
 www.danishhurst.com







